

"SCHEDULE B - MAPS"

Lot 1233 in Deposited Plan 753135



Land & Property  
Information

A division of the Department of Finance & Services

# Certified Copy

**This is to certify that**

**the Registrar General for New South Wales  
HEREBY CERTIFIES for the purposes of the  
*Evidence Act 1995* that the annexed is a copy  
of a public document number**

CP 3963-1871

containing 1 page(s) which is this  
day in the custody of the Registrar General



Registrar General <sup>RP</sup>

13 JUL 2016

Date





When R 412 from Occupation for Residence or Business Purposes Not 9 E 94  
 When R 1667(M) from Alienation for Mining or Mining Purposes Not 15-12-22  
 Within the Bourke, Cooper, Dowling and Gips Gold Field Proclaimed 15.12.1880

## NOTATION PLAN

### PLAN OF PORTION 1233

Parish of Wyalong County of Gipps  
 LAND DISTRICT OF WYALONG LAND BOARD DISTRICT OF FORBES  
 BLAND SHIRE

Applied for under the 75<sup>th</sup> Section of the Crown Lands Consolidation Act 1913 by Stanley Guy Compton

Sp.L. 443  
 For 1233 Sp.L. 443 Stanley Guy Compton New G.L. 451 27<sup>th</sup> Dec 1946 Stanley Guy Compton  
 G.L. 451 Area enclosed per 1243 of 752-370 Total area now 27 ac 2 r 21 p Total 1700 New  
 450 G.L. 123 incl No 1202 No 1234 of 179 In 250

1137	1136	1135	1134	1133
G 9676	G 9676	G 9676	G 9676	G 9676
0.2.29	0.1.19	0.2.05	0.2.05	0.7.19

ROAD 50' 100' 100'

ROAD 150' 100'

ROAD 150' 100'

1233

R 472 from Occupation  
or Business Purposes

For Residence

Notified 9.6.94

15.12.22

20ac.

Mining or Mining

unobstructing Stanley Guy Compton

thick mathe

leady

363' 54"

2000'

30' 0" 1000'

270' 00" 1800'

179' 54"

R 1667(M) from Alienation for  
Purposes Not 9

PLAN MICROFILMED

IN ADDITION TO AGREEMENT TO BE MADE

I CERTIFY that this is a CORRECT COPY of the original plan of survey of all locations shown hereon being the plan of the custody thereof.

R. Coakley  
Surveyor-General  
24<sup>th</sup> Dec 1946

Approved under X.Y.  
Field Book L.D. 1185 Page 2

Corner	Survey	Page	Book	F. or P.
A	Numbered Peg	1233	179' 58' 6"	Pp 50
B	Numbered Peg	1233		
C	Numbered Peg	1233		
D	Numbered Peg	1233	353' 58' 6"	Pp 50

Side	Survey	Station

Scale 4 Chains to an inch

Cat. No G3963/1171

Richard Buchhorn  
Magpie Magpie

A Survey registered under the Survey Act 1913 do hereby solemnly and sincerely declare that the survey represented in this plan has been made by me in accordance with the Survey Practice Regulations 1913 and the special requirements of the Department of Lands was completed on the 2<sup>nd</sup> August 1946, and the reference marks have been placed as shown herein.

R. Buchhorn  
Surveyor registered under the Survey Act 1913

Subscribed and declared before me at Magpie Magpie on the 5<sup>th</sup> day of December 1946

H. W. Phillips  
Justice of the Peace

Witnessed in the District Court with my later of 20 Dec 1946

Checked and Certified F. H. Freaguard 21.9.46

Examined and Plan approved R. T. Hawks

Surveyor-General  
24<sup>th</sup> April 1946



Land & Property  
Information

A division of the Department of Finance & Services

# Certified Copy

This is to certify that

the Registrar General for New South Wales  
**HEREBY CERTIFIES** for the purposes of the  
*Evidence Act 1995* that the annexed is a copy  
of a public document number

CP 4026-1871

containing 1 page(s) which is this  
day in the custody of the Registrar General



Registrar General *R.P.*

13 JUL 2016

Date



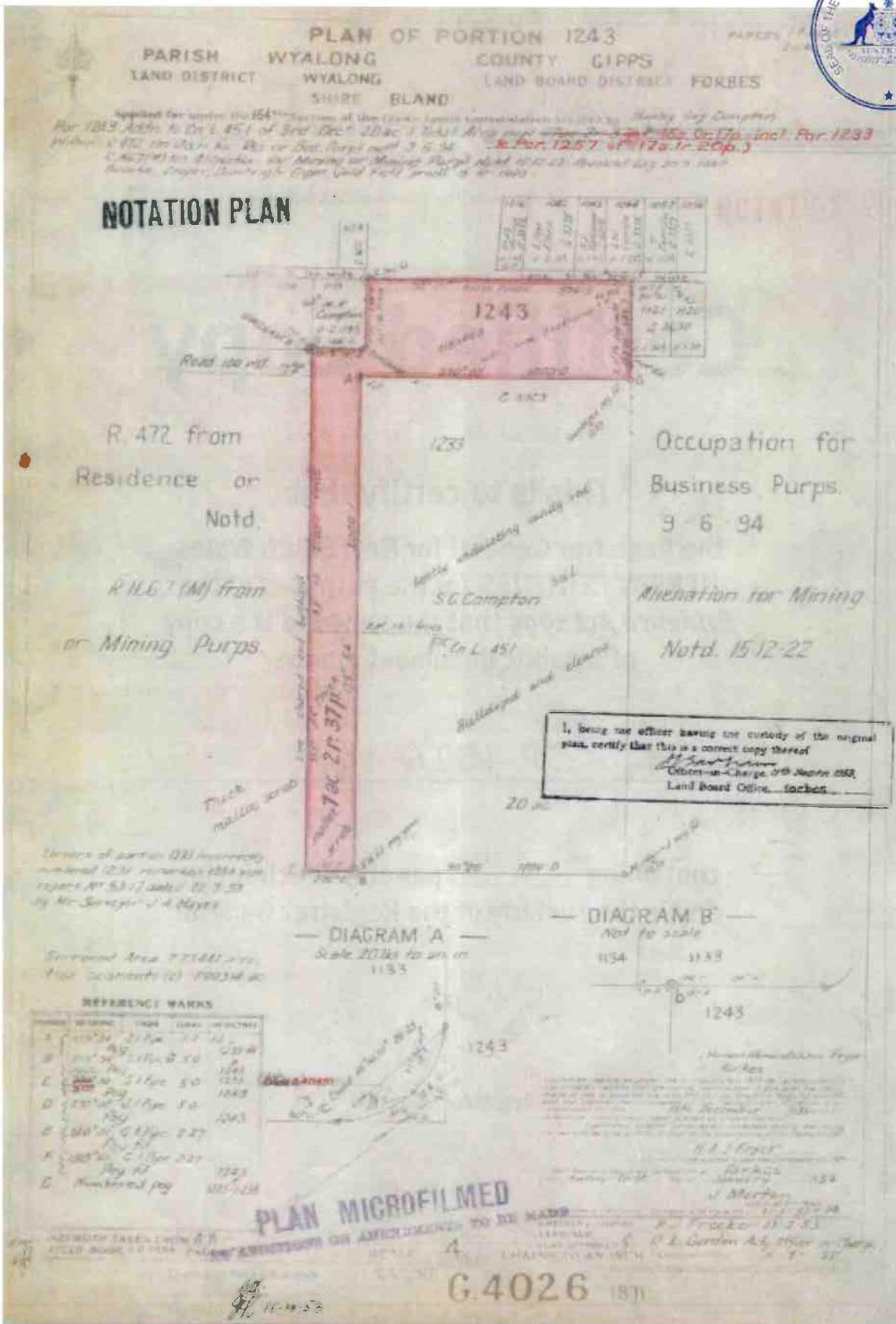



**Land & Property  
Information**

A division of the Department of Finance & Services

# Certified Copy

**This is to certify that**

**the Registrar General for New South Wales  
HEREBY CERTIFIES for the purposes of the  
*Evidence Act 1995* that the annexed is a copy  
of a public document number**

CP 4049-1871

containing 1 page(s) which is this  
day in the custody of the Registrar General



Registrar General *RP*

13 JUL 2016

Date





**PLAN OF PORTION 1257**  
**PARISH WYALONG COUNTY GIPPS**  
**LAND DISTRICT WYALONG LAND BOARD DISTRICT FORBES**  
**SHIRE BLAND ENVIRONS OF WYALONG**

Applied for under the 164<sup>th</sup> Section of the Crown Lands Consolidation Act, 1913, by Stanley Guy Compton  
 Within R.472 fm. Occ. for Res. or Bus. Purps. Notified 3rd June, 1894.  
~~R.1667 fm. Alienation for Mining or Mining Purposes Act 15th Dec. 1922~~ (Revised 1923, 1924)  
 Bourke, Cooper, Dowling & Gipps Gold Field Purpos. Proc. 15<sup>th</sup> October, 1880.  
 Portion 1257: Addition to Cn. L. 45.1, 3rd. Dec. of 27a. 2r. 37p. (Total Area Now 45a. 0r. 17p. incl. Pors. 1233 & 1243)  
*Case 11153*

**NOTATION PLAN**

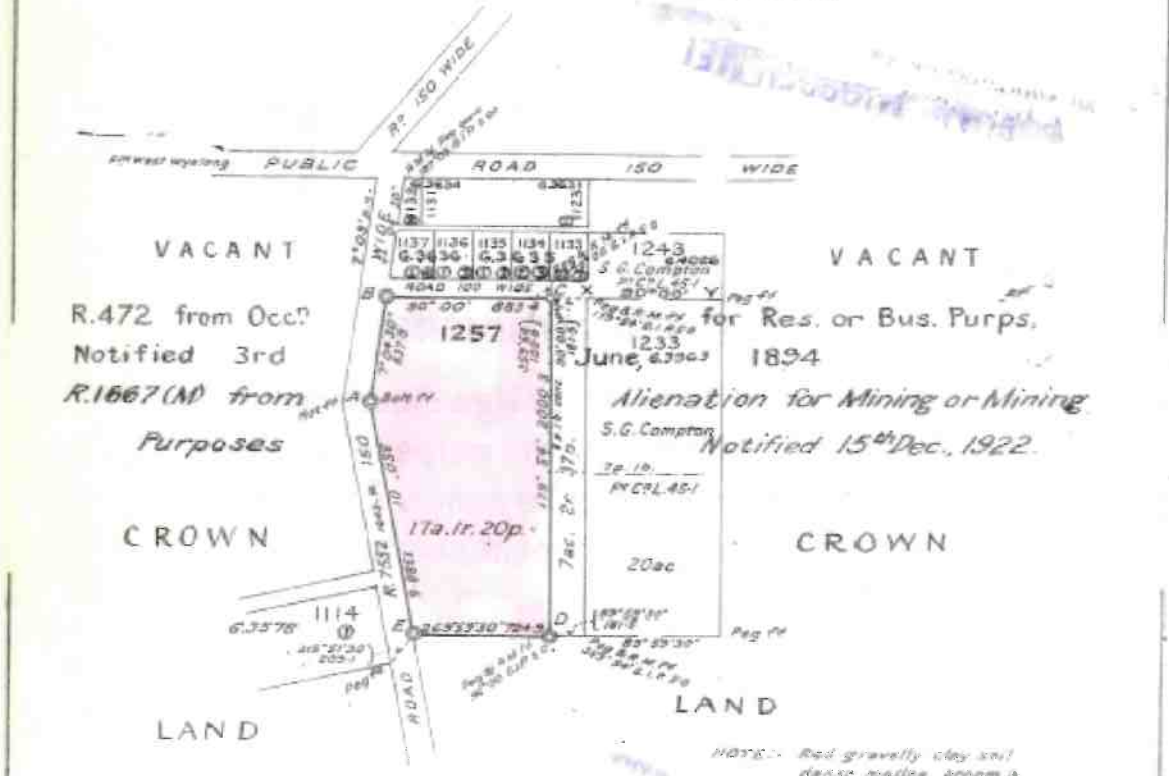

① Vacant Crown Land  
 ② Freehold  
 ③ Area: 2r. 19 3/4 p.  
 ④ Area: 2r. 25 p.  
 Surround Area: 17.3868 ac.

**REFERENCE MARKS**

NUMBER	BEARING	FROM	SINKS	SP ON TREE
A	N 52° 45'	S. I. Ppe	2-30	+
B	Number	peg on cor.	1257	
C	187° 04' 30"	S. I. Ppe	2-29	
D	Number	peg on cor.	1257	
E	30° 00'	S. I. Ppe	5-0	
F	Number	peg on cor.	1257	
G	89° 52' 30"	S. I. Ppe	2-30	

AZIMUTH TAKEN FROM XY.  
 FIELD BOOK L.D. 2559, PAGES 31 & 32

*R.K.*  
**NOTATION PLAN.**  
 I CERTIFY that this is a CORRECT COPY of the original plan of survey and of all notations thereon now relevant, I being the officer having the custody thereof.

Officer in Charge, 27.10.1924  
 Land Board Office

*James Anthony Taylor*  
 Surveyor  
 I HEREBY certify that the foregoing plan, 1257, is a true and correct copy of the original plan of survey and of all notations thereon now relevant, I being the officer having the custody thereof, and I make this solemn declaration conscientiously believing the same to be true and by virtue of the provisions of the Statute in that behalf made.

Subscribed and sworn to before me this 27th day of October 1924  
 Justice of the Peace  
 1257

SCALE EIGHT CHAINS TO AN INCH

CAT. N<sup>o</sup> G. 4049-1871